

ELECTRONIC TRIKE

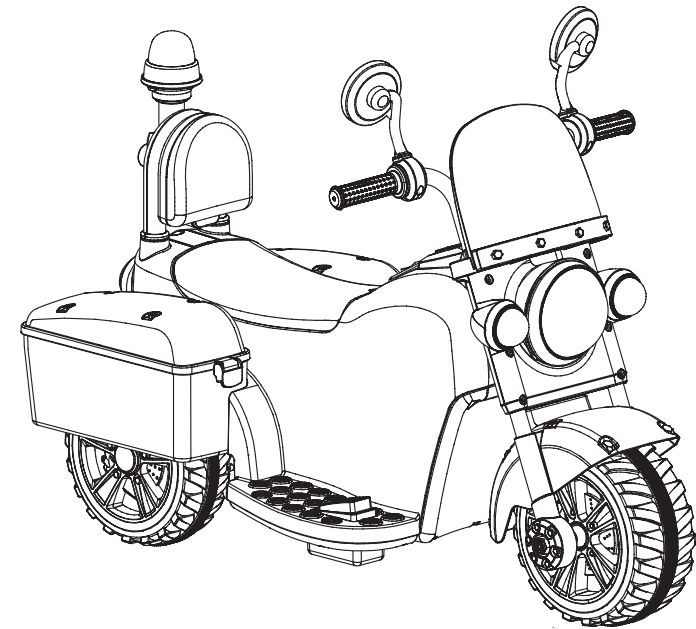

INSTRUCTION MANUAL

Read and understand this entire manual before assembly or use

IMPORTANT

Age:
2Years+

Maximum
user weight:
25Kg

WARNING!

1. For family and domestic use only.
2. Not to be used in traffic.
3. Adult assembly required.
4. Warning! Protective equipment should be worn.
5. This toy has no brake.
6. Warning: It is dangerous to use the toy in areas other than private grounds.
7. Never leave child unattended. Direct adult supervision is required.
8. Never use on roadways, near cars, on or near steep inclines or steps, swimming pools or other bodies of water.



This instruction manual contain important information which will help you get the best from your product and ensure safe and correct assembly, use and maintance. Please read the instruction manual fully before use. Failure to do so may result in damage to the vehicle or harm to the user. Please keep this instruction manual for future reference.

Before first time use, charge the battery for at least 8-12 hours, no more than 20 hours.

If you need help or have damaged or missing parts, call the Customer Helpline:

www.htigroup.co.uk
customerservice@htigroup.co.uk
 +44 (0)1253 775570



Designed & Manufactured by HTI Toys,
 Copse Road, Fleetwood, FY7 7NY – UK
 Made in China

TABLE OF CONTENTS

P. 1	ABOUT YOUR NEW ELECTRONIC TRIKE
P. 2-3	PARTS LIST
P. 4	PARTS DIAGRAM
P. 5-7	ASSEMBLY STEPS
P. 8-9	CHARGING YOUR ELECTRONIC TRIKE
P. 10	HOW TO OPERATE YOUR ELECTRONIC TRIKE
P. 11	TROUBLESHOOTING GUIDE
P. 12	MAINTAINING YOUR ELECTRONIC TRIKE
P. 13	DISPOSAL OF BATTERY

ABOUT YOUR NEW ELECTRONIC TRIKE

Thank you for your purchasing our product, Keep these points in mind as you read this guide:





Suitable Age:	2+ years	Battery:	DC 6V 4.0AH *1
Load Capacity:	Under 25Kg	Size Of Carriage:	890*520*600mm
Speed:	2.5-3 km/h	Optimum Temperature:	Below 40°C Avoid to use under burning sun
Material:	PP	Charging Time:	8-12 hours, maximum 20 hours
Charger:	230-240V 50Hz Output: DC 6V Current: 500mA Model No.: LK-D060050 Type: Type G	Fuse:	F 5A, Self-resetting
		Battery Life:	Max. 300 times fully charged

WARNING!

FOR THE SAFETY OF YOUR CHILD, PLEASE READ ALL WARNINGS AND ASSEMBLY/USE INSTRUCTIONS. KEEP THIS GUIDE FOR FUTURE REFERENCE.

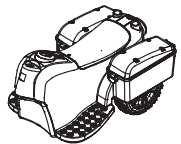
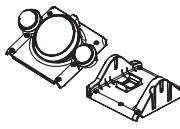
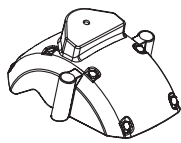

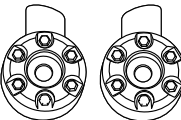
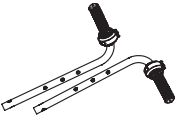
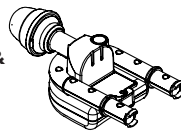



- **ADULT ASSEMBLY REQUIRED.** The product contains small parts, which are for adult assembly only. Keep children away when assembling.

PARTS LIST

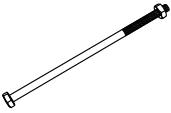
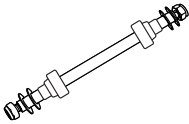
PART NO.	PART NAME	PICTURE	Qty (pcs)	REMARKS	PART NO.	PART NAME	PICTURE	Qty (pcs)	REMARKS
1	Body		1		2	Front Fairing		1	
3	Mud Guard		1		4	Windscreen		1	
5	Wheel Decor		1 Pair	Left & Right	6	Front Fork		1 Pair	Left & Right
7	Back Rest & Light Pole		1		8	Front Wheel		1	

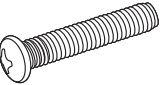
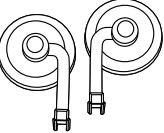
PARTS LIST

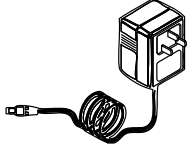
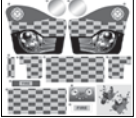
ASSEMBLY PACKAGE

PART NO.	PART NAME	PICTURE	Qty (pcs)	REMARKS	PART NO.	PART NAME	PICTURE	Qty (pcs)	REMARKS
9	Bolt		1		10	Front Axle		1	
11	M4X12 Screw		4		12	M5 Nut		6	
13	M5X28 Bolt		6		14	Rear View Mirror		1 Pair	Left & Right
15	Spanner		2		16	Charger		1	
17	Decal		1		18	Instruction Manual		1	

PARTS DIAGRAM

1	Vehicle Body *1	2	Front Fairing*1	3	Mud Guard*1
4	Windscreen*1	5	Wheel Decor*2	6	Front Fork*2
7	Back Rest & Light Pole*1	8	Front Wheel*1	9	Bolt*1
10	Front Axle*1	11	M4X12 Screw*4	12	M5 Nut*6
13	M5X28 bolt*6	14	Rear View Mirror*2		

NOTE: Some parts are on the axles

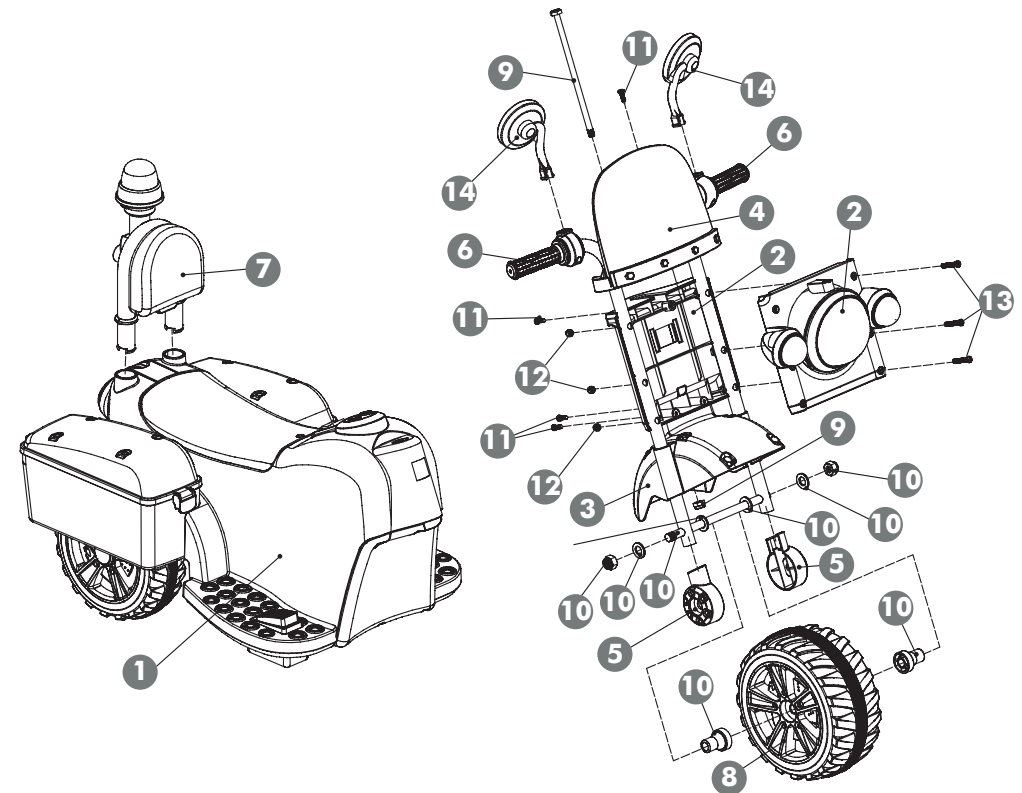

Tools Required



Screwdriver
(not included)



Pliers
(not included)



Spanner

ASSEMBLY STEPS

- This product requires adult assembly. Please set aside at least 40 minutes for assembly.
- Children can be harmed by small parts, sharp edges and sharp points in the vehicle's unassembled state. Care should be taken in unpacking and assembly of the vehicle. Children should not handle parts, or help in assembly of the vehicle.
- Please identify all parts before assembly and save all packaging material until assembly is complete to ensure that no parts are discarded.
- Assembly tools needed: screwdriver(not included), pliers (not included), spanner.

Step 1

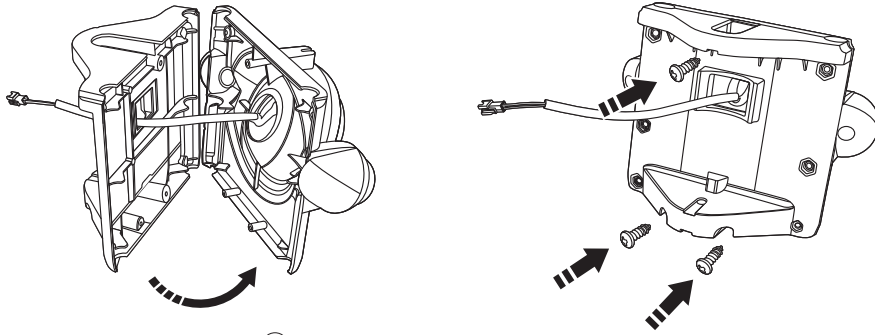

- Close Front and Back Front Fairing (2).
- Put the cable through the hole and fix with 3pcs M4x12 screws (1).

Step 2

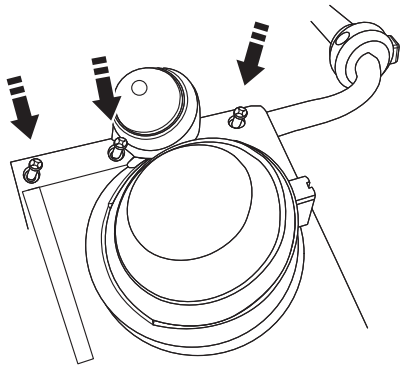

- Insert Front Fork (6) into Front Fairing. Fix with 6pcs M5x28 Bolt (13) and M5 Nut (12).
- Follow Left / Right Symbol on Front Fork.

Step 3

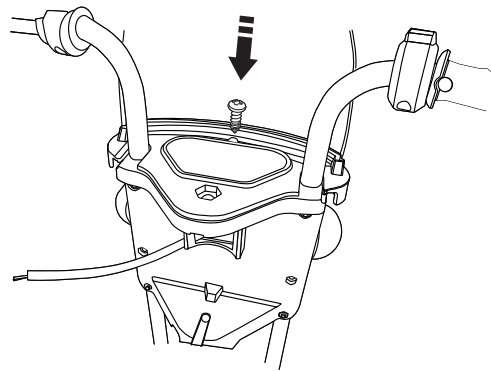

- Put the Windscreen (4) onto Front Fairing and fix with 1pc M4x12 screw (11).

ASSEMBLY STEPS

Step 4

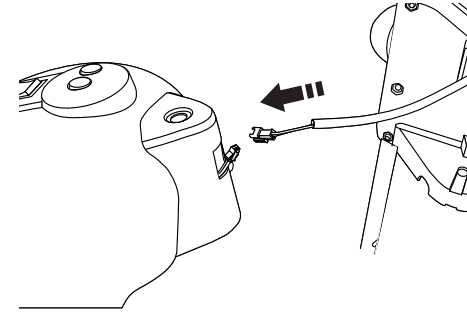

- Connect the wire of Front Fairing and Body (1).

Step 5

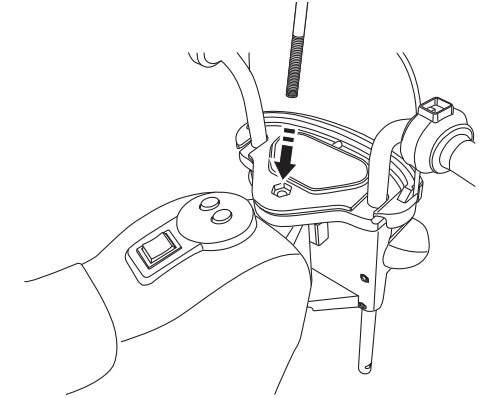

- Remove the nut of the Bolt (9). Put the bolt through Front Fairing and Body.

Step 6

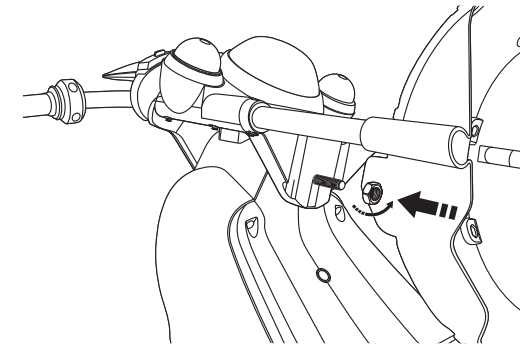

- Put Mud Guard (3) through the legs of the front fork and fix with M5 nut (12)

Step 7

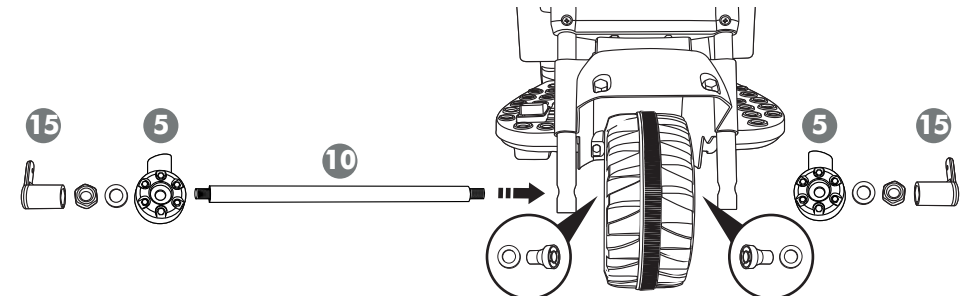

- Install Front Wheel (8) with Front Axle (10) as diagram shown and tighten with spanners provided (15)

ASSEMBLY STEPS

Step 8

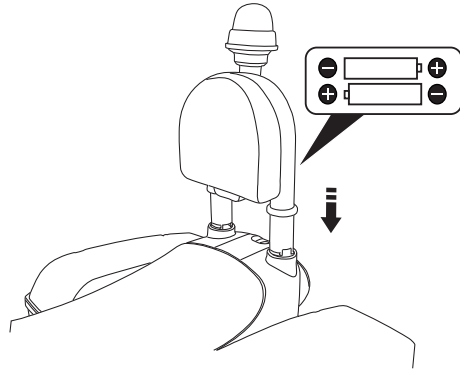

- Insert 2 x AA batteries into Back Rest & Light Pole (7). Insert Back Rest & Light Pole (7) into Bike Body to fix it.

BATTERY INSTALLATION & REPLACEMENT

- Loosen the screw by a screwdriver to open the battery compartment.
- Insert / replace the new batteries in the correct direction indicated inside the battery compartment.
- Close the compartment and screw shut securely.

BATTERY SAFETY PRECAUTION

- Non-rechargeable batteries are not to be recharged.
- Rechargeable batteries are to be removed from the toy before being charged.
- Rechargeable batteries are only to be charged under adult supervision.
- Different types of batteries or new and used batteries are not to be mixed.
- Only batteries of the same or equivalent type as recommended are to be used.
- Batteries are to be inserted with the correct polarity. (+ and -)
- Exhausted batteries are to be removed from the toy.
- The supply terminals are not to be short-circuited.
- Do not dispose of batteries in fire; batteries may leak or explode.
- Batteries should be replaced by an adult.
- Do not mix old and new batteries
- Do not mix alkaline, standard (carbon-zinc) or rechargeable batteries.



DISPOSAL AND RECYCLING

Electrical product waste should not be discarded with household waste. Please actively support us in conserving resources and protecting the environment by returning the non-working electrical products to an appropriate disposable/ recycling centre (if available).

Please retain this instruction for reference.

Step 9

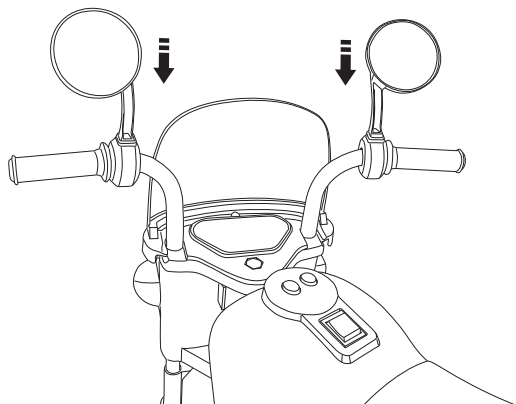

- Insert Rear View Mirrors (14) into the handles.

CHARGING YOUR TRIKE

⚠ WARNING!

- The **PEDAL SWITCH** must not be pressed when charging.
- This product has **CHARGING PROTECTION**: When charging, all the functions will be cut off!

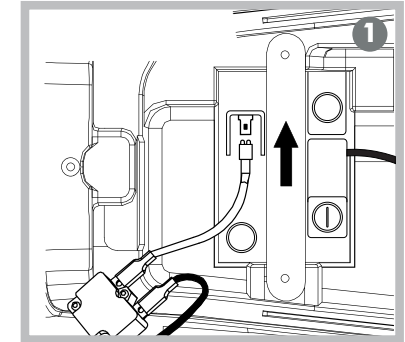
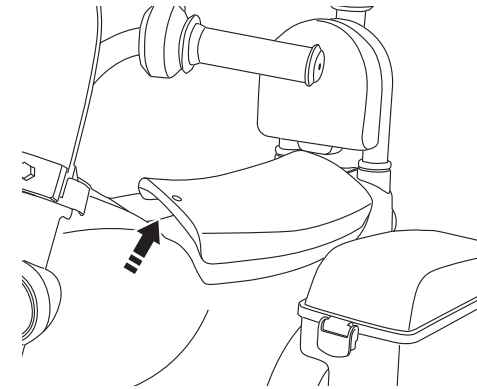

1. Unscrew and open the seat. Connect battery with **RED** wire. Then screw the seat back in place.

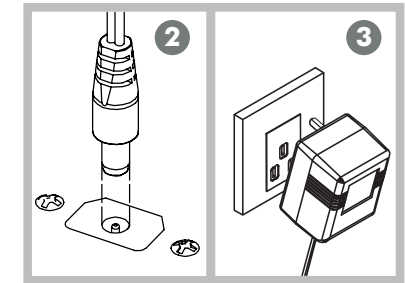
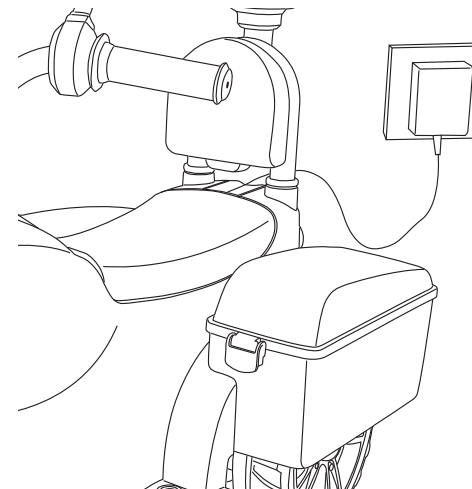

2. Plug into the jack. Connector jack is located at the back of the trike body.
3. Plug in the adaptor pin into socket to start charging.

CHARGING YOUR TRIKE

⚠️ WARNING!

• PREVENT FIRE AND ELECTRIC SHOCK:

- Explosive gasses are created during charging. Do not charge near heat or flammable materials. Charge the battery in a well-ventilated area **ONLY**.
- **NEVER** pick up the battery by the wires or charger. Damage can occur to the battery and may cause a fire. Pick up the battery by the case **ONLY**.
- This toy contains batteries that are non-replaceable.
- Charge the battery in a dry area **ONLY**.
- Wash hands after handling.
- Do not open the battery. Battery contains lead acid and other materials that are toxic and corrosive.
- Do not open the charger. Exposed wiring and circuitry inside case may cause electric shock. Only adults may handle or charge the battery. **NEVER** allow child to handle or charge the battery. Battery is heavy and contains lead acid (electrolyte).
- Do not drop the battery. Permanent damage to the battery could occur or cause serious injury.
- Before charging the battery, check for wear or damage to the battery, charger, its supply cord and the connectors. **DO NOT** charge the battery if any damage to parts has occurred.
- Do not allow the battery to drain completely. Recharge the battery after each use or once a month if not used regularly.
- Do not charge battery upside down.
- Always secure the battery with the bracket. Battery can fall out and injure a child if carriage tips over.
- A recommendation for adult supervision of young children.
- The toy should be used with caution since skill is required to avoid falls or collisions causing injury to the user or third parties.

ONLY AN ADULT CAN CHARGE AND RECHARGE THE BATTERY!

⚠️ WARNING!

- For the purpose of recharging the battery, only use the detachable supply unit provided with this toy. **NEVER** substitute the battery or the charger with another brand. Using another battery or charger may cause a fire or explosion.
- Do not use the battery or charger for any other product. Overheating, fire or explosion could occur.
- **NEVER** modify the electric circuit system. Tampering with the electric system may cause a shock, fire or explosion or may permanently damage the system.
- Do not allow direct contact between battery terminals. Fire or explosion can occur.
- Do not allow any type of liquid on the battery or its components.

HOW TO OPERATE YOUR TRIKE

MUST CONFIRM BEFORE USING THAT THE FOLLOWING WORK HAS BEEN COMPLETED:

- Important! Before using the Trike for the first time, the battery needs to be charged for 8 to 12 hours, no more than 20 hours. Only an adult can charge or recharge the battery.
- Finish assembly according to the steps that the manual described.
- All places that need a screw guarantee the screw has been locked.

Rules for Safe Riding

READ THESE RULES ALOUD TO YOUR CHILD AND THEIR PLAYMATES AND MAKE SURE THEY UNDERSTAND THEM!

- This Trike has no brake. Always wear a helmet and protective clothing when riding.
- Direct adult supervision required.
- Keep children within safe riding areas.
- Never use in roadway, near motor carriages, on lawn space, on or near steep inclines or steps, swimming pools or other bodies of water.
- Use the toy only on flat surfaces, such as inside your house, garden or playground.
- Never use in the dark. A child could encounter unexpected obstacles and have an accident. Operate the Trike only in the daytime or a well-lit area.
- It is not recommended to drive the Trike on wet surfaces or on slopes of greater than 15 degrees.
- Do not use this Trike outdoors when it is raining or snowing.
- Make sure you come to a complete stop before changing directions from forward to reverse.
- Please follow the correct weight and age limits allowed to drive this Trike.
- It is prohibited to change the circuit or add other electric parts
- Inspect wires and connections of the Trike periodically.
- In order to avoid accidents, please ensure the Trike is safe before riding.
- Do not let any child touch the wheels or be near them when the Trike is moving.

FORWARD & BACKWARD

- To operate the Trike, select a gear from the gear selection switch, there are 3 settings- Forward, neutral/off and reverse.
- Once you have selected a gear, depressing the pedal will engage the motor and move the Trike in the direction you selected.
- If you require to change direction - you must always release the pedal and come to a complete stop before selecting a new gear. Failing to do so will result in damage to the gear selection switch and/or the motor and gear box.

STEERING

- The handle bars can be used to steer the bike left or right, when in forward motion.
- Please note that when the Trike is being used in reverse, the controls will also be reversed and some coordination by the driver may be required to keep the bike under control.

SOUNDS

- The sound effects can be operated by pressing the buttons shown above, they are not connected to the light on the light pole.

LIGHTS

- The only working lights are the headlight & the rear siren light on the light pole.
- The headlight is activated when the pedal is pressed and the trike is being driven.
- The rear siren light on the light pole is operated by the button shown.

AFTER USE

- When you have finished using the Trike set the power switch to the neutral / off position.

IMPORTANT!

Always stop the Trike when changing direction to avoid damage to the gear box and motor.

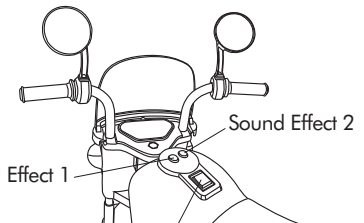

Gear Selection Switch

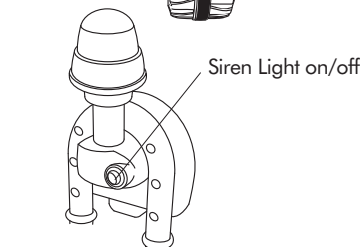
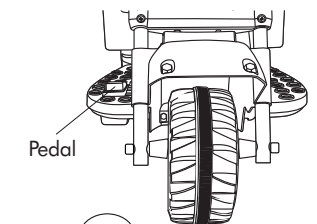

TROUBLESHOOTING GUIDE

- **PROBLEM: THE TRIKE DOES NOT RUN.**

PROBLEM CAUSE: The battery may be low on power.

After each use, or once a month minimum, charge the battery for 8-12 hours. Do not leave the battery on charge for more than 20 hours.

POSSIBLE CAUSE: Thermal fuse has tripped.

The Trike is equipped with a self-resetting fuse. When the Trike is overloaded or operated incorrectly; the self-resetting fuse will be cut off for 5-20 seconds before becoming operational again. The self-resetting fuse is under the seat (Refer to the picture.)

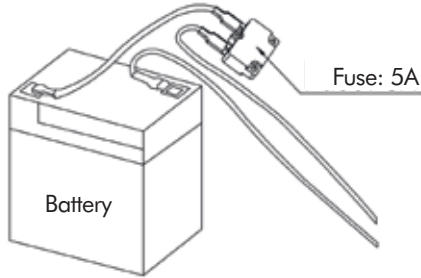

To avoid the fuse cut off the power, follow these guidelines:

DO NOT overload the Trike,
Maximum weight allowed: 25 kg
DO NOT tow anything behind the Trike.
DO NOT drive up steep slopes.
DO NOT drive into fixed objects, which may cause the wheels to spin, causing the motor to overheat.
DO NOT drive in very hot weather, components may overheat.
DO NOT tamper with the electric system, doing so may create a short circuit, causing the fuse to trip.

POSSIBLE CAUSE: Wheel nuts are loose.

If the nuts are not tight, the wheels will not engage the forward gears. Tighten the nut with the nut wrench.

POSSIBLE CAUSE: Battery connector or wires are loose.

Make sure the battery connectors are firmly plugged into each other.

POSSIBLE CAUSE: Battery is dead.

Have you properly maintained the battery according to the directions? Is the battery old? Your battery may need to be replaced.

POSSIBLE CAUSE: Electric system is damaged.

Water may have corroded the system, or loose dirt, gravel or sand might have jammed the switch.

POSSIBLE CAUSE: Motor is damaged.

The motor needs professional repair.

- **PROBLEM: THE BATTERY WILL NOT RECHARGE.**

POSSIBLE CAUSE: Battery connector or adapter connector is loose.

Make sure the battery connector and adapter connector are firmly plugged together.

POSSIBLE CAUSE: Charger is not plugged in.

Make sure the charger is plugged into the wall outlet and the power flow to the outlet is on.

POSSIBLE CAUSE: Charger is not working.

Is the charger warm while charging? If not, the charger may be broken and may need to be replaced.

- **PROBLEM: THE TRIKE DOES NOT RUN VERY LONG.**

POSSIBLE CAUSE: Battery may be undercharged.

You may not be charging the battery long enough. After each use, or once a month minimum, charge the battery for 8 to 12 hours. Do not leave the battery on charge for more than 20 hours.

POSSIBLE CAUSE: Battery is old.

The battery will eventually lose the ability to hold a charge. Depending on the amount of use, and varying conditions the battery should operate for one to three years. Replace the battery with a new one.

- **PROBLEM: BATTERY BUZZES OR GURGLES WHEN CHARGING.**

This is normal and not a cause for concern. It may also be silent when charging, which is also normal.

- **PROBLEM: CHARGER FEELS WARM WHEN RECHARGING BATTERY.**

This is normal and not a cause for concern.

MAINTAINING THE TRIKE

- It is the parents' responsibility to check main parts of the Trike before using, must regularly examine for potential hazard, such as the battery, charge, cable or cord, plug, screws or fastening enclosure of other parts and that in the event of such damage, the Trike must not be used until that damage had been properly removed.

- Make sure the plastic parts of the Trike are not cracked or broken.

- Occasionally use a lightweight oil to lubricate moving parts such as wheels.

- Park the Trike indoors or cover it to protect it from wet weather.

- Keep the Trike away from sources of heat, such as stoves and heaters. Plastic parts may melt.

- Recharge the battery after each use. Only an adult can handle the battery. Recharge the battery at least once a month when the Trike is not being used.

- Do not wash the Trike with a hose. Do not wash the Trike with soap and water. Do not drive the Trike in rain or snowy weather. Water will damage the motor, electric system and battery.

- Clean the Trike with a soft, dry cloth. To restore shine to plastic parts, use a non-wax furniture polish. Do not use car wax. Do not use abrasive cleaners.

- Do not drive the Trike in loose dirt, sand or fine gravel which could damage moving parts, motors or the electric system.

- When not using, all the electrical source should be turn off. Turn off the power switch and disconnect the battery connection.

DISPOSAL OF BATTERY

- Your sealed lead-acid battery must be recycled or disposed of in an environmentally sound manner.
- Do not dispose of your lead-acid battery in a fire. The battery may explode or leak.
- Do not dispose of a lead-acid battery in your regular, household trash. The incineration, land filling or mixing of sealed lead-acid batteries with household trash is prohibited by law.
- Return an exhausted battery to your local approved lead-acid battery recycle, such as a local seller of automotive batteries.
- Contact your local waste management officials for other information regarding the environmentally sound recycling and disposal of lead-acid batteries.
- The battery must be charged only by adult .Please charge the product before using!
- The toy should not be connected to excessive powers (more than the quantity specified herein), and it should not be operated during charging process.
- Any rechargeable battery must only be charged under adult's supervision.
- Battery charger should regularly check the wires, plugs, casing and other parts for damage and if found should stop using and restored.
- All batteries should be inserted with the correct polarity. (+ and -)
- The battery charger used with the toy are to be regularly examined for damage to the cord, plug, enclosure and other parts, in the event of such damage, they must not be used until that damage had been repaired.

